

Riverside Mills - Launceston

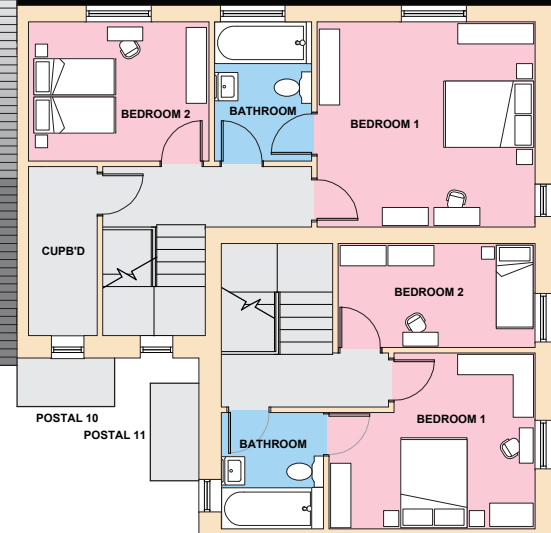
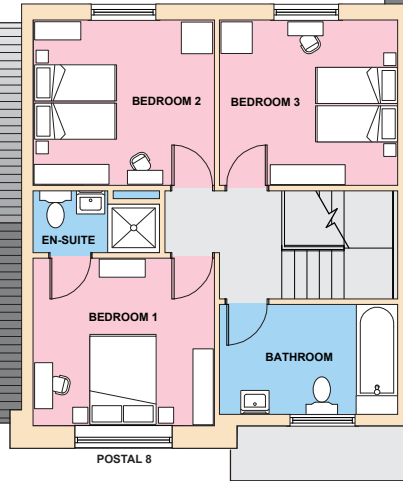

Second floor layouts - postal no's 8, 10 and 11

Postal 8:-

- Bed 3 - 10'1" x 10'5"
- Bed 2 - 9'9" x 10'6"
- Bed 1 - 10'10" x 9'10"
- En-suite - 7'6" x 3'7"
- Bathroom - 6'10" x 10'10"

Postal 10:-

- Bed 2 - 10'10" x 8'2"
- Bathroom - 8'2" x 5'11"
- Bed 1 - 12'2" x 13'1"

Postal 11:-

- Bed 2 - 12'2" x 6'0"
- Bed 1 - 12'2" x 10'6"
- Bathroom - 6'11" x 5'11"