

Riverside Mills - Launceston

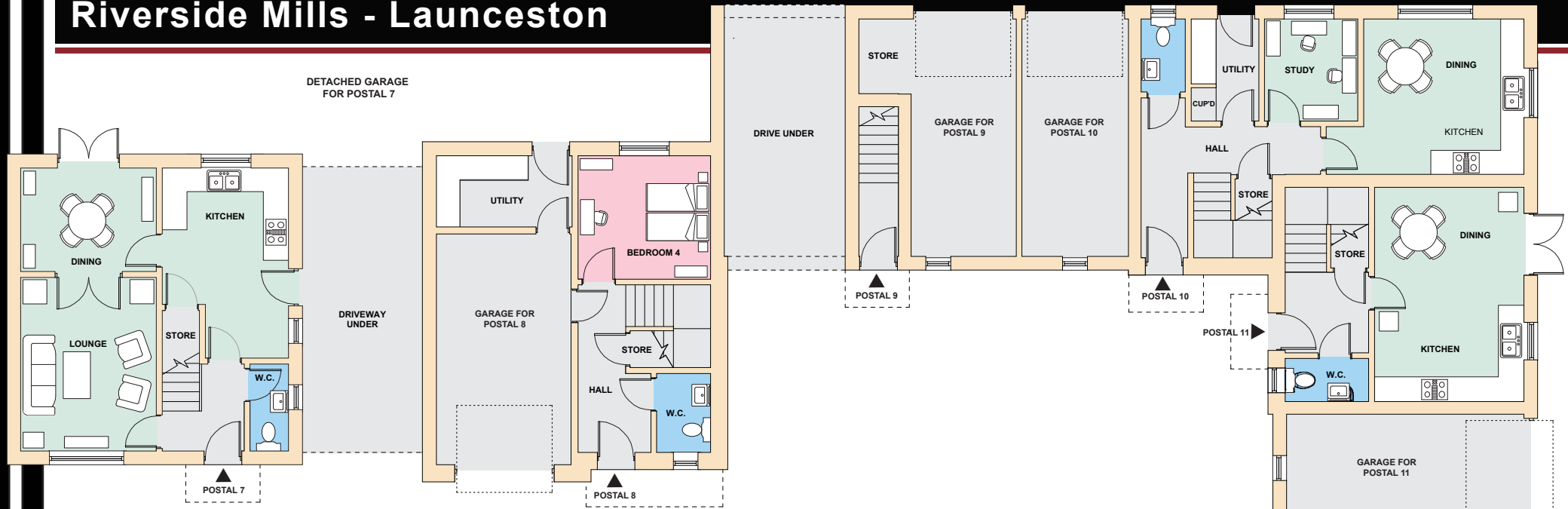

Ground floor layouts - postal no's 7, 8, 9, 11 and 12

Postal 7:-

Hall - 6'7" x 6'3"
 Cloakroom - 6'11" x 3'0"
 Kitchen - 15'1" x 9'11"
 Dining - 8'3" x 10'9"
 Lounge - 13'9" x 10'9"

Postal 8:-

Hall - 13'8" x 5'9"
 Cloakroom - 4'3" x 6'5"
 Bed 4 - 10'1" x 10'11"
 Utility - 5'7" x 10'9"

Postal 10:-

Hall - 23' x 3'7"
 Cloakroom - 6' x 3'3"
 Utility - 8' x 5'7"
 Study - 8'2" x 7'5"
 Kitchen/Dining - 12'8" x 12'4"

Postal 11:-

Hall - 6'7" x 6'7"
 Cloakroom - 6' x 3'3"
 Kitchen/Dining - 12'1" x 17'

